



Colocate at WBX, Connect to the World.

As one of the largest carrier hotels in the USA, the Westin Building Exchange serves as a primary hub for carrier, cloud, and content interconnection.

Through our extensive Fiber Meet-Me Room, WBX affords neutral connectivity to Asian, Canadian, European, and American network service providers and carriers. WBX also provides access to numerous other networks via the Seattle Internet Exchange (SIX) and the Pacific Northwest GigaPoP (PNWGP).

AVAILABILITY

Colocation

- ±73,000 SF retail colocation
- Modular cages (200-10K SF)
- Individual locking cabinets
- Access to copper/fiber MMR

Rooftop Access

- Multiple antenna towers with lines of sight to the North, South, and West.

CONNECTIVITY

Fiber

- Carrier Neutral Facility with more than 200 carriers and service providers
- Dark Fiber Availability
- Premier Fiber and Copper Meet-Me Rooms
- Multiple fully diverse underground main points of entry (MPOE)

Carriers

Major regional, national, global carriers, cable and mobile providers, subsea cable providers including, but not limited to Alaska CS, AT&T, BCE Nexxia, Bell Canada, CenturyLink/Level 3, Charter, China Telecom, Cogent, Comcast, Frontier, GCI, GTI, GTT, Hawaiki, Hurricane Electric, NTT, PC-1, Peer 1, Rogers, Shaw, Southern Cross, Sprint, Tata, Telia, Telstra, Telus, T-Mobile, Verizon, Wave, and Zayo

INFRASTRUCTURE

Power

- Up to 150 Watts/SF (higher wattage available)
- AC and DC power available

Cooling

- Five diverse cooling towers
- N+1 redundancy
- 330,000+ gallons make-up water available

Floor Loading

- Typical structural capacity allowing for 1200 lb. to 1500 lb. cabinets.

Fire Safety

- Pre-action dry-pipe fire suppression system

Seismic

- Built to seismic zone 3 standards
- Seismic retrofit completed in 2007
- Located on million-year compact/stable base

CERTIFICATIONS

Compliance

- PCI/SSAE 16 SOC I Compliant

RELIABILITY

UPS Power

- N+1 or 2N power redundancy available
- 24/7 battery monitoring system

Utility Power

- Multiple 13.5 kV feeds
- Diverse Substations
- Multiple transformer vaults - 480V3 Phase

Generator Backup

- 18 diesel generators, totaling 19.5 MW

Managed Services

- 24x7x365 onsite engineering staff
- 24x7x365 remote hands
- Certified technicians

SECURITY

Access

- 2 secure mantrap entries
- All colocation spaces equipped with dual-authentication biometric entries

Staff

- 24/7/365 onsite security staff
- 24/7/365 CCTV monitoring

COLOCATION AMENITIES

- 2-hr parking near entrance (at standard rates)
- Colocation customer care suite with TV, couches, conference room and kitchen
- Colocation customer lounge
- On site storage available

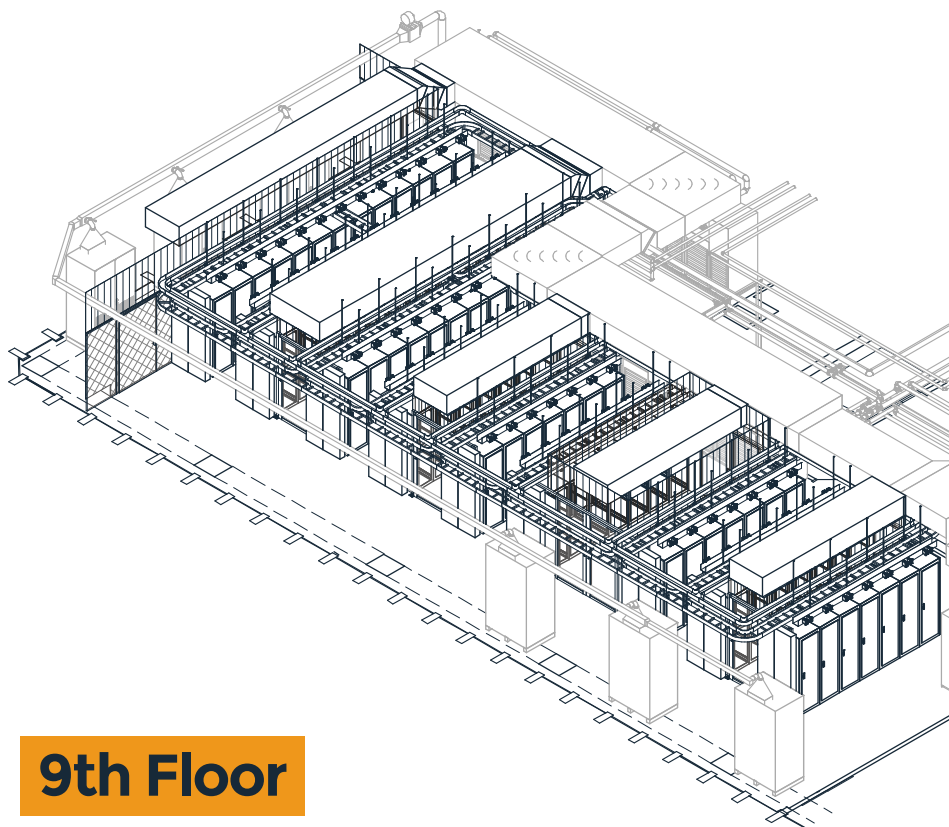

9th Floor

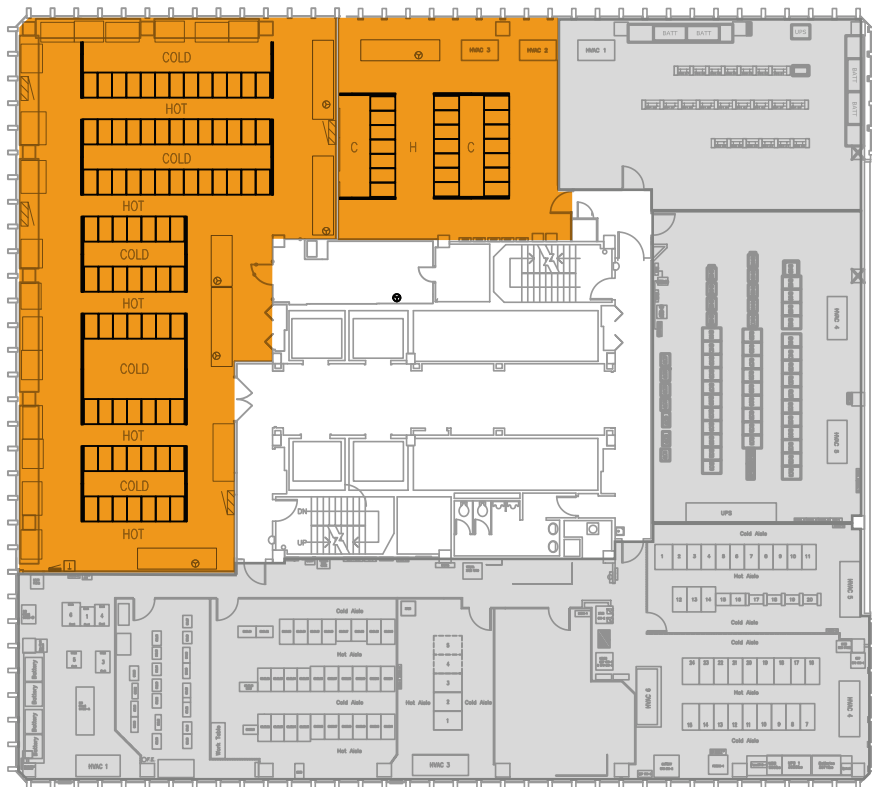

Available

Occupied